

| | | | | |
|-----|-------------------------------|--------|----|-------|
| REV | ECO NO. | DATE | BY | APP'D |
| A | REL TO PRODUCTION PER ECO 001 | 1/5/06 | KL | |

Product Specification

Material

Insulator : Glass-Filled Thermoplastic
UL94V-0 rates, Color-Black

Contact : Brass or Phosphor Bronze
Plated full gold or selected gold in mating area, 100u" min. tin-lead on termination area, with entire contact under-plated 50u" min. Nickel

Electrical

Contact Resistance :30 milliohms
Max at 1 AMP DC.

Insulation Resistance 1000 magohms at 500 VDC

Dielectric Withstanding Voltage :
500 VAC/rms 60HZ for 1 minute

Current Rating : 1 AMP

Voltage Rating :250 VAC/rms
60HZ

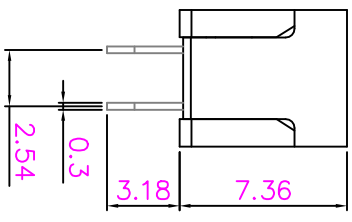
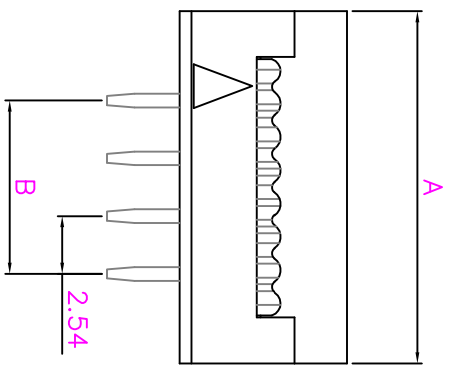
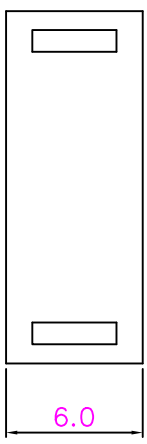

| Positions | A | | B | |
|-----------|-------|-------|-----------|-----------|
| | A | B | Positions | Positions |
| 8 | 15.48 | 7.62 | 18 | 28.18 |
| 10 | 18.02 | 10.16 | 20 | 30.72 |
| 12 | 20.56 | 12.70 | 24 | 35.84 |
| 14 | 23.10 | 15.24 | 28 | 40.88 |
| 16 | 25.64 | 17.78 | 30 | 43.42 |

| | |
|-----------|-------|
| Tolerance | ±0.35 |
| .x | ±0.25 |
| .xx | ±0.25 |

UNIT: mm

CONFIDENTIAL



IDC Transition

© Copyright 2006 Regal Electronics, Inc.
This drawing is the property of Regal Electronics and contains confidential information, trade secret information and/or know-how which is the property of Regal Electronics. By accepting this drawing, the recipient agrees not to provide, or otherwise make available, the drawing or any information or know-how embodied therein, to any third party without prior written authorization.

| | | | |
|-----------|-----|------|--------|
| DRAWN: | KIM | DATE | 1/5/06 |
| CHECKED: | | DATE | |
| ENGINEER: | | DATE | |
| APPROVED: | | DATE | |
| APPROVED: | | DATE | |
| APPROVED: | | DATE | |

| | | | | | | | |
|--------|------|-------|---|--------------|-------|------|---|
| SCALE: | NONE | SIZE: | B | DRAWING NO.: | R4082 | REV: | A |
| SHEET | 1 | OF | 1 | | | | |

NOTE:
This component and all homogeneous subcomponents are RoHS compliant